

TECHNICAL SPECIFICATIONS

FD60-100-5



## STANDARD SPECIFICATIONS

CHARACTERISTICS			TCM		TCM	
			FD60-5	FD70-5	FD80-5	FD100-5
1.01	Manufacturer					
1.02	Manufacturer's model designation					
1.03	Power source		Diesel	Diesel	Diesel	Diesel
1.04	Operator type		Seated	Seated	Seated	Seated
1.05	Load capacity	Q (kg)	6000	7000	8000	10000
1.06	Load center distance	c (mm)	600	600	600	600
1.08	Load distance, axle to fork face (forks lowered)	x (mm)	615	625	720	715
1.09	Wheelbase	y (mm)	2300	2300	2500	2800
WEIGHT						
2.01	Truck weight without load / including battery (simplex mast, lowest lift height)	kg	8670	9540	11510	12910
2.02	Axle loading with maximum load, front/rear (simplex mast, lowest lift height)	kg	13030/1640	14640/1900	17360/2150	20660/2250
2.03	Axle loading without load, front/rear (simplex mast, lowest lift height)	kg	3860/4810	3910/5630	5140/6370	5980/6930
WHEELS, DRIVE TRAIN						
3.01	Tyres: V= solid, L= pneumatic, SE= solid pneumatic - front/rear		L / L	L / L	L / L	L / L
3.02	Tyre dimensions, front		8.25X15-14PR	8.25X15-14PR	9.00X20-14PR	9.00X20-14PR
3.03	Tyre dimensions, rear		8.25X15-14PR	8.25X15-14PR	9.00X20-14PR	9.00X20-14PR
3.05	Number of wheels, front/rear (x=driven)		4x / 2	4x / 2	4x / 2	4x / 2
3.06	Track width (center of tyres), front	b10 (mm)	1470	1470	1600	1600
3.07	Track width (center of tyres), rear	b11 (mm)	1700	1700	1700	1700
DIMENSIONS						
4.01	Mast tilt, forwards/backwards	α/β °	6-12	6-12	6-12	6-12
4.02	Height with mast lowered (see tables)	h1 (mm)	2500	2500	2800	2850
4.03	Free lift (see tables)	h2 (mm)	205	215	205	205
4.04	Lift height (see tables)	h3 (mm)	3000	3000	3000	3000
4.05	Overall height with mast raised	h4 (mm)	4420	4420	4420	4330
4.07	Height to top of overhead guard	h6 (mm)	2550	2550	2660	2660
4.08	Seat height	h7 (mm)	1470	1470	1570	1570
4.12	Tow coupling height	h10 (mm)	520	520	590	590
4.19	Overall length	l1 (mm)	4805	4875	5245	5485
4.20	Length to fork face (includes fork thickness)	l2 (mm)	3585	3655	4025	4265
4.21	Overall width	b1/b2 (mm)	- / 2005	- / 2005	- / 2175	- / 2245
4.22	Fork dimensions (thickness, width, length)	s / e / l (mm)	60 / 150 / 1220	70 / 150 / 1200	75 / 180 / 1200	75 / 180 / 1220
4.23	Fork carriage to DIN 15 173 A/B/no		4A	4A	4A	Shaft-type
4.24	Fork carriage width	b3 (mm)	1845	1845	2015	2208
4.31	Ground clearance under mast, with load	m1 (mm)	200	200	240	240
4.32	Ground clearance at centre of wheelbase, (forks lowered)	m2 (mm)	225	225	290	290
4.33	Working aisle width with 1000 x1200 mm pallets, crosswise	Ast (mm)	5215	5285	5630	5865
4.34a	Working aisle width with 800 x1200 mm pallets, crosswise	Ast (mm)	5015	5085	5430	5665
4.34b	Working aisle width with 800 x1200 mm pallets, lengthwise	Ast (mm)	5415	5485	5830	6065
4.35	Turning circle radius	Wa (mm)	3400	3460	3710	3950
4.36	Minimum distance between centers of rotation	b13 (mm)	1255	1255	1290	1475
PERFORMANCE						
5.01	Travel speed, with/without load	km/h	25.0 / 28.0	25.0 / 28.0	24.0 / 28.0	24.0 / 27.0
5.02	Lifting speed, with/without load	m/s	0.53 / 0.55	0.53 / 0.55	0.44 / 0.46	0.03 / 0.05
5.03	Lowering speed, with/without load	m/s	0.45 / 0.50	0.45 / 0.50	0.45 / 0.45	0.45 / 0.35
5.05	Rated drawbar pull, with/without load	N	54900 / 21600	54900 / 21600	59800 / 27500	63700 / 31400
5.06	Maximum drawbar pull, with/without load (5 min short duty)	N	- / -	- / -	- / -	- / -
5.07	Gradeability, with/without load	%	28 / 20	28 / 20	25 / 20	21 / 20
5.08	Maximum gradeability, with/without load	%	- / -	- / -	- / -	- / -
5.09	Acceleration time (10 metres) with/without load	s	- / -	- / -	- / -	- / -
5.10	Service brakes (mechanical / hydraulic / electric / pneumatic)		Hydraulic	Hydraulic	Hydraulic	Hydraulic
ENGINE						
7.01	Manufacturer / Type		Kubota V3800	Kubota V3800	Kubota V3800	Kubota V3800
7.02	Rated / Nominal output to ISO 1585**	kW	81	81	81	81
7.03	Rated speed to DIN 70 020	rpm	2400	2400	2400	2400
7.04	Number of cylinders / cubic capacity	cm³	4 / 3769	4 / 3769	4 / 3769	4 / 3769
7.05	Fuel consumption according to VDI 60 cycle	l/h / kg/h	10	11	12	13
7.06	Max torque	Nm	385	385	385	385
7.07	Max torque at engine speed	rpm	1500	1500	1500	1500
MISCELLANEOUS						
8.01	Type of drive control		Powershift 2/2	Powershift 2/2	Powershift 2/2	Powershift 2/2
8.02	Maximum operating pressure for attachments	bar	206	206	206	206
8.03	Oil flow for attachments	l/min	117	117	117	117
8.04	Noise level, value at operator's ear (EN 12053)	dB(A)	86	86	86	86
8.05	Towing coupling design / DIN type, ref.		Pin	Pin	Pin	Pin

## DIMENSIONS FD60-100-5

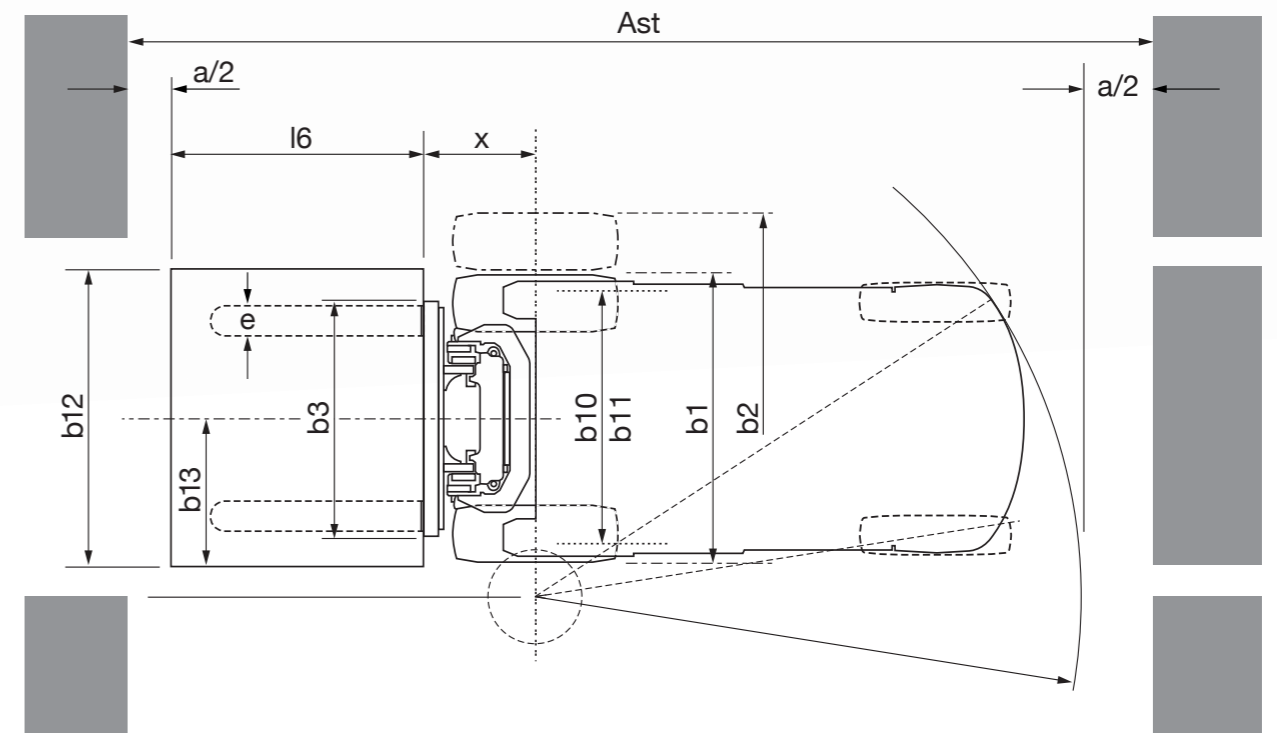
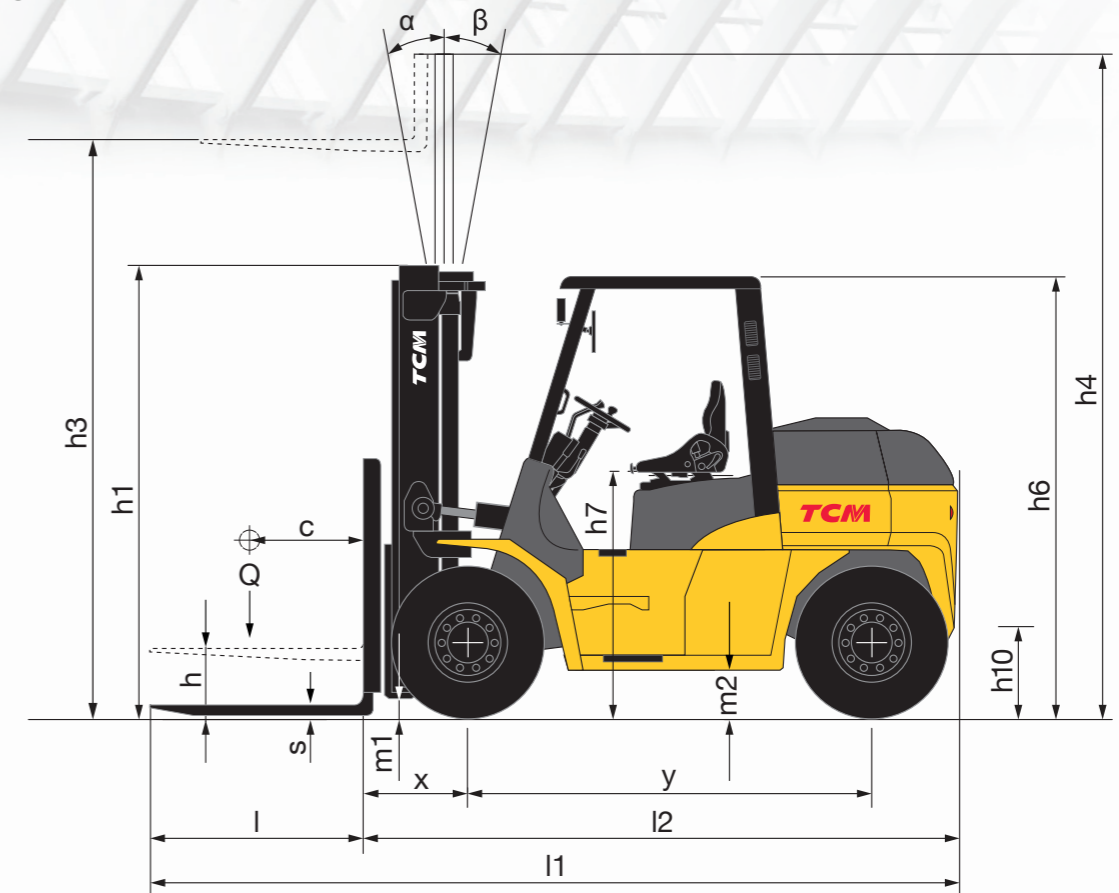

## MAST SPECIFICATIONS & RATED CAPACITIES

### FD60-5

MAST TYPE	Max fork height (mm)	Overall mast height (mm)			Free lift (mm)		Mast Tilt (Degrees Forward/Backward)	Load capacity (kg) @ 600 mm load centre		
		Lowered	Extended		With backrest	Without backrest				
			With backrest	Without backrest						
TWO STAGE	3000	2500	4420	3950	205	205	6-12	6000		
	3300	2650	4720	4250						
	3500	2750	4920	4450						
	4000	3050	5420	4975						
	4500	3300	5920	5475						
	5000	3550	6420	5975						
	5500	3850	6920	6525						
TWO STAGE FULL FREE LIFT	6000	4100	7420	6430	1255	1580	6-6	5700		
							3-6	5400		
	3000	2625	4420	4095			6-12	1730	6-12	6000
	3300	2775	4720	4395						
	3500	2875	4920	4595						
	4000	3175	5420	5095						
	4500	3425	5920	5595						
5000	3725	6420	6095							
THREE STAGE FULL FREE LIFT	4000	2500	5400	5075	1130	1455	6-10	5800		
	4350	2625	5750	5425						
	THREE STAGE FULL FREE LIFT	4800	2775	6200	5875	1405	1730	6-10	5700	
		5000	2875	6400	6075					
		5500	3130	6900	6575					
		6000	3300	7400	7075					
		7000	3675	8400	8075					
		8000	4100	9400	9075					
				1760	2085	3-6	5000			
							2255			
				2305	2630	4000				
				2730	3055	2500				

### FD70-5

MAST TYPE	Max fork height (mm)	Overall mast height (mm)			Free lift (mm)		Mast Tilt (Degrees Forward/Backward)	Load capacity (kg) @ 600 mm load centre		
		Lowered	Extended		With backrest	Without backrest				
			With backrest	Without backrest						
TWO STAGE	3000	2500	4420	4105	215	215	6-12	7000		
	3300	2650	4720	4405						
	3500	2750	4920	4605						
	4000	3050	5420	5105						
	4500	3300	5920	5605						
	5000	3550	6420	6105						
	5500	3850	6920	6605						
TWO STAGE FULL FREE LIFT	6000	4100	7420	7105	1265	1590	6-6	6600		
							3-6	6400		
	3000	2625	4420	4095			6-12	1740	6-12	7000
	3300	2775	4720	4395						
	3500	2875	4920	4595						
4000	3175	5420	5095							
THREE STAGE FULL FREE LIFT	4500	3425	5920	5595	1415	1740	6-10	6800		
	4000	2500	5400	5075						
	4350	2625	5750	5425						
	4800	2775	6200	5875						
	5000	2875	6400	6075						
	5500	3130	6900	6575						
	6000	3300	7400	7075						
	7000	3675	8400	8075						
				1770	2095	3-6	6400			
							2265			
				2315	2640	4500				
				2740	3035	2700				

## MAST SPECIFICATIONS & RATED CAPACITIES

### FD80-5

MAST TYPE	Max fork height (mm)	Overall mast height (mm)			Free lift (mm)		Mast Tilt (Degrees Forward/Backward)	Load capacity (kg) @ 600 mm load centre		
		Lowered	Extended		With backrest	Without backrest				
			With backrest	Without backrest						
TWO STAGE	3000	2800	4420	4230	205	205	6-12	8000		
	3300	2950	4720	4445						
	3500	3050	4920	4645						
	4000	3350	5420	5145						
	4500	3600	5920	5645						
	5000	3850	6420	6145						
	5500	4150	6920	6645						
TWO STAGE FULL FREE LIFT	6000	4400	7420	7145	1345	1580	6-6	7750		
							3-6	7400		
	3000	2700	4420	4210			6-12	1730	6-12	8000
	3300	2850	4720	4510						
	3500	2950	4920	4710						
4000	3250	5420	5210							
THREE STAGE FULL FREE LIFT	4500	3500	5920	5710	1895	2130	6-10	7700		
	4000	2575	5400	5165						
	4350	2700	5750	5515						
	4800	2850	6200	5965						
	5000	2950	6400	6165						
	5500	3205	6900	6665						
	6000	3375	7400	7165						
	7000	3750	8400	8165						
				1850	2085	3-6	7300			
							2255			
				2395	2630	5400				
				2820	3055	3500				

### FD100-5

MAST TYPE	Max fork height (mm)	Overall mast height (mm)		Free lift (mm)	Mast Tilt (Degrees Forward/Backward)	Load capacity (kg) @ 600 mm load centre
		Lowered	Extended without backrest*			
TWO STAGE	3000	2850	4330	205	6-12	10000
	3300	3000	4630			
	3500	3100	4830			
	4000	3400	5330			
	4500	3650	5830			
	5000	3900	6330			
	5500	4200	6830			
	6000	4450	7330			
				6-6	9000	
						3-6

\* Carriage is bar type - backrest is not available standard or as an option

## STANDARD AND OPTIONS LIST

	FD60-5	FD70-5	FD80-5	FD100-5
<b>GENERAL</b>				
Default canvas roof	●	●	●	●
Headguard deletion	●	●	●	●
2 Rear view mirrors (OHG mounted)	●	●	●	●
Rear view mirror center mounted	●	●	●	●
Large size rear view mirror	●	●	●	●
Heater drivers area	●	●	●	●
Tilt cylinder boots	●	●	●	●
Tilt cylinder cover	●	●	●	●
Power steering boots	●	●	●	●
Fingertip lever hydraulic control	●	●	●	●
<b>HYDRAULIC CONTROL</b>				
2-way control valve MC	●	●	●	●
3-way control valve MC	●	●	●	●
4-way control valve MC	●	●	●	●
5-way control valve MC	●	●	●	●
4-way control valve FC	●	●	●	●
5-way control valve FC	●	●	●	●
<b>MAST, FORKS AND CARRIAGE</b>				
Loose Mast	●	●	●	●
Carriage wide-Simplex	●	●	●	●
Carriage extra wide-Simplex	●	●	●	●
Integral sideshifter for shaft type forks – Simplex	●	●	●	●
Integral sideshifter for hook type forks – Triplex	●	●	●	●
<b>ELECTRICS</b>				
Load weight indicator (cannot be combined with ARMDC)	●	●	●	●
Mast tilt gauge	●	●	●	●
OK monitor (checks battery fluid, air cleaner dust and coolant status)	●	●	●	●
High volume back-up buzzer	●	●	●	●
Torque converter temperature gauge	●	●	●	●
Wide range REAR working lights	●	●	●	●
Wide range of Strobe lights	●	●	●	●
Wide range FRONT working lights	●	●	●	●
Rear LED red line warning light (activated by reverse lever)	●	●	●	●
Backup handle with horn button	●	●	●	●
<b>TYRES</b>				
Pneumatic dual tyre-drive / single tyre-steer	●	●	●	●
Solid pneumatic dual tyre-drive / single tyre-steer	●	●	●	●
Solid pneumatic dual tyre-drive / single tyre-steer (soft comp.)	●	●	-	-
Solid pneumatic dual tyre-drive / single tyre-steer (white)	●	●	●	●
<b>AIR INTAKE AND EXHAUST</b>				
Air intake pre-cleaner	●	●	●	●
Exhaust cover	●	●	●	●
CCV heater	●	●	●	●

**KEY** ● Standard ● Option - Not available

